

D DOOR NICHE SIZE

A DOOR NICHE SIZE

B DOOR NICHE SIZE

C DOOR NICHE SIZE

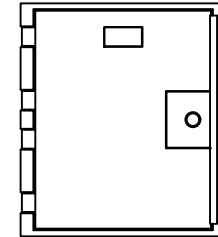
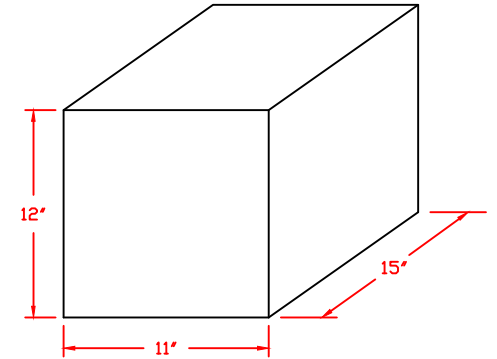
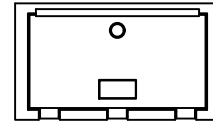
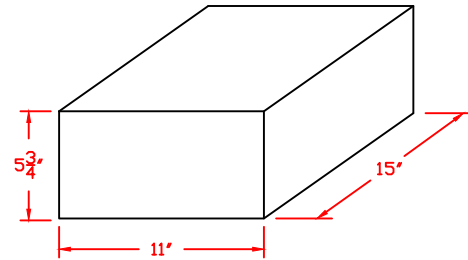
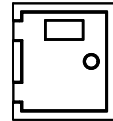
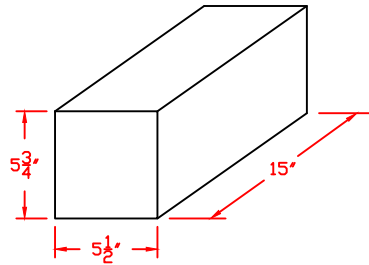
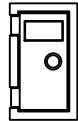
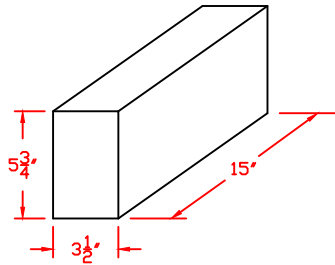

A DOOR PASS THROUGH SIZE

B DOOR PASS THROUGH SIZE

C DOOR PASS THROUGH SIZE

D DOOR PASS THROUGH SIZE

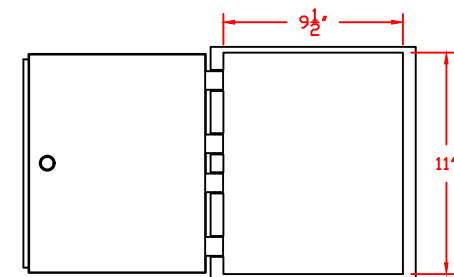
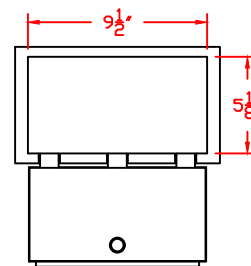
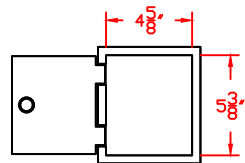
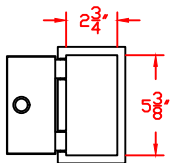

**POSTAL PRODUCTS  
UNLIMITED, INC.™**

Postal Products Unlimited, Inc.  
500 W. Oklahoma Ave.  
Milwaukee, WI 53207-2649  
www.postalproducts.com  
(800) 229-4500

**Columbarium Door Niche And Pass Through Dimensions**

**Notes:**

Niche size specifies the maximum inner compartment size.  
Pass through size specifies the maximum door opening size.

Tolerance:  $\pm \frac{1}{8}$ "

Date: 11/16/23

Scale: NTS

Drawn By: CKV

Checked By: BJK